

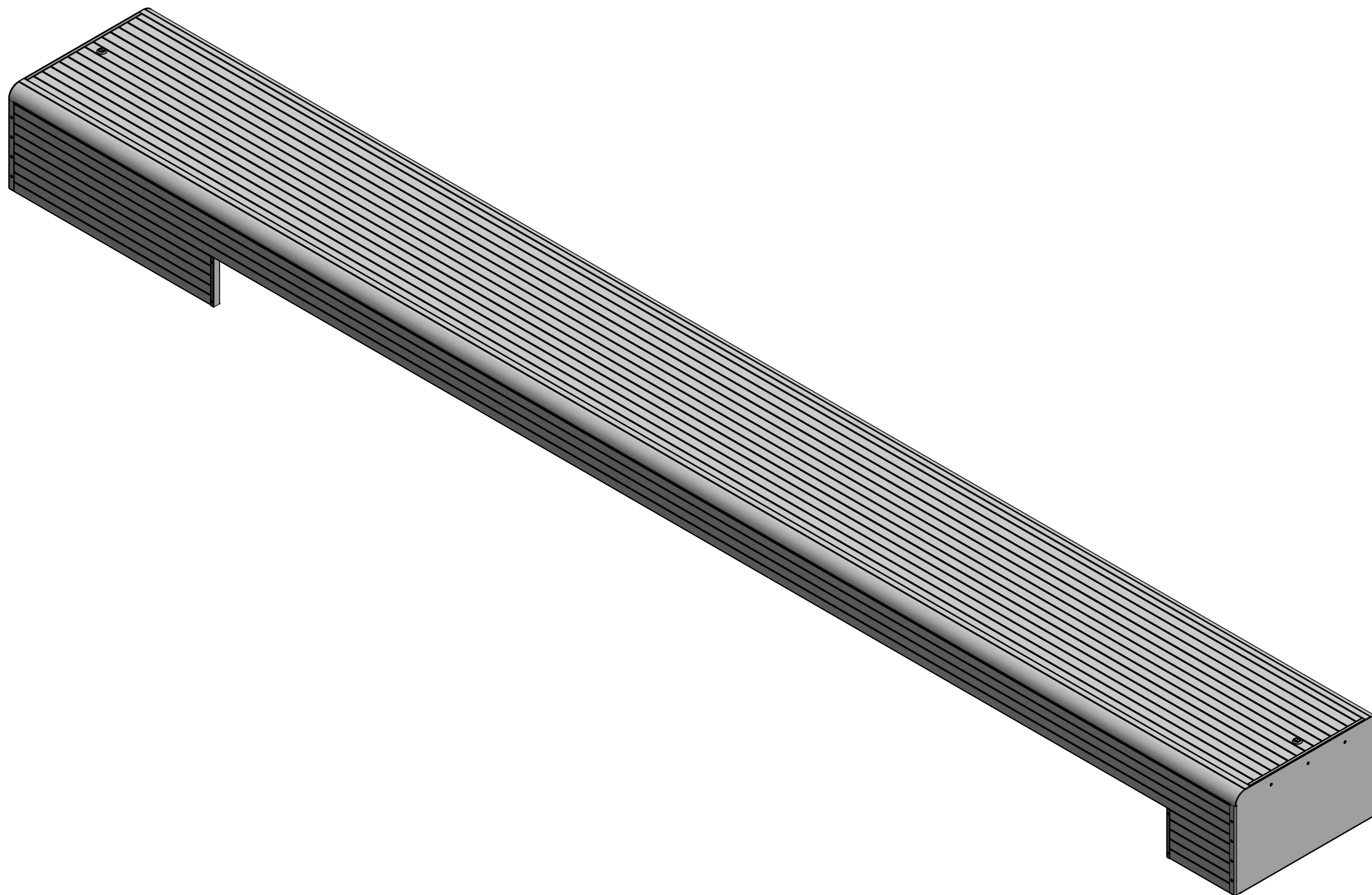

#A3358 - ALUMINUM BENCH INSTALLATION INSTRUCTIONS





BENCH DIMENSIONS

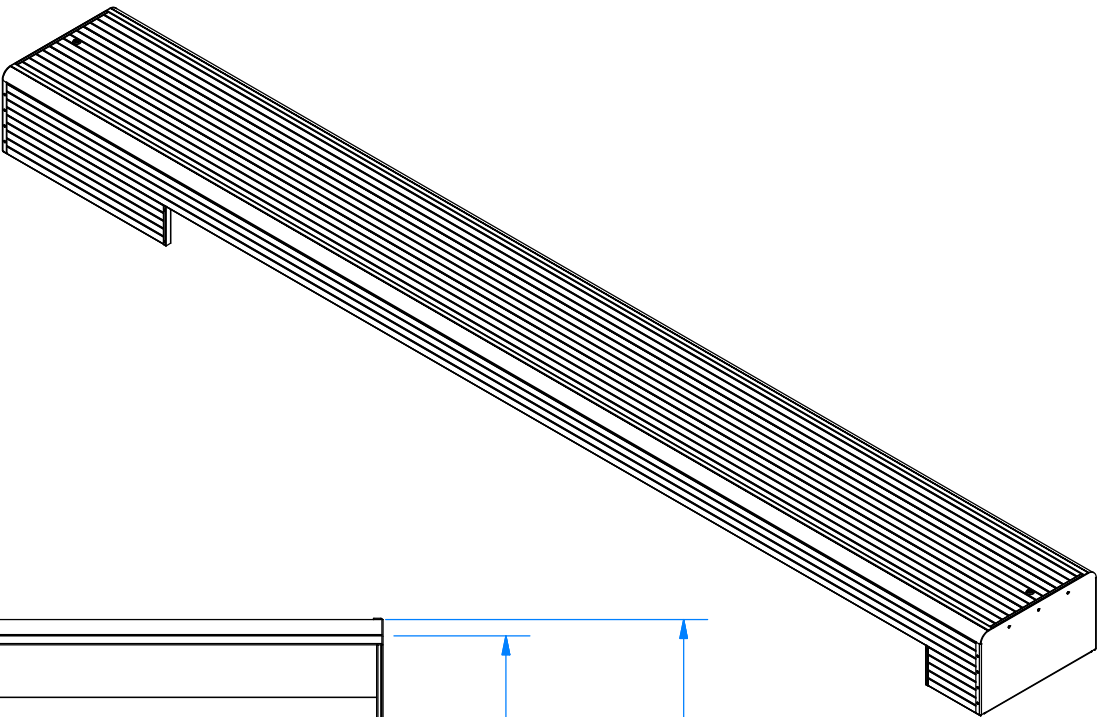

TOP

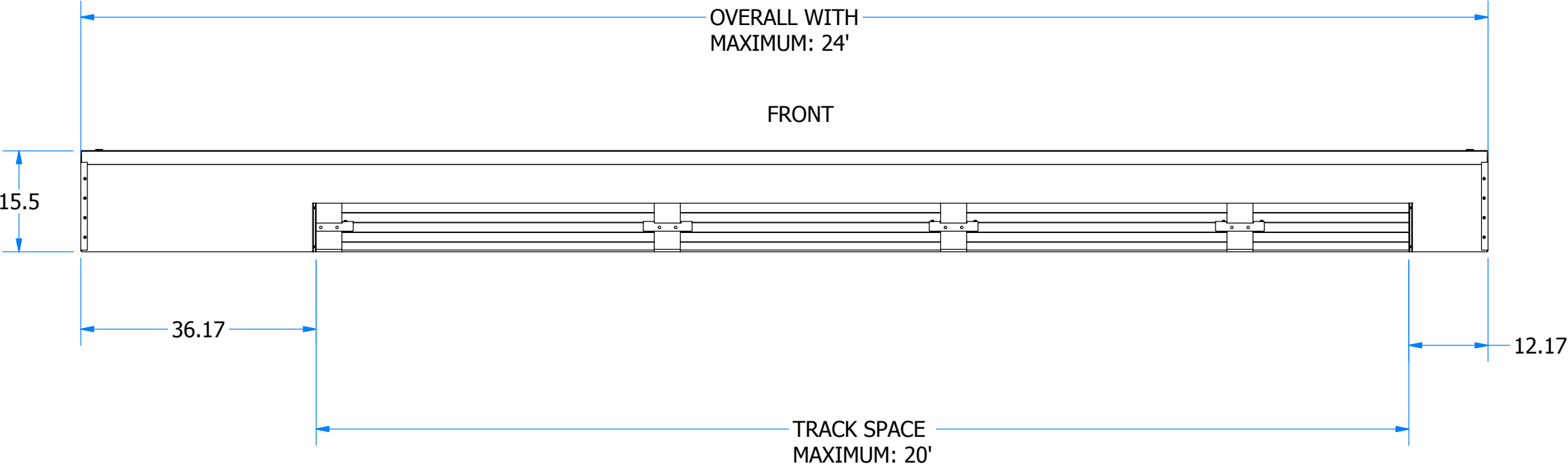
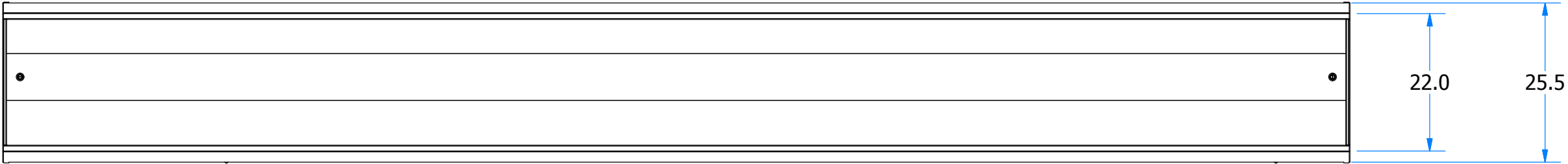

SIDE

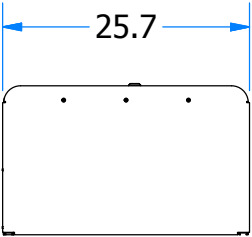



Required Tool & Parts List

1. Skill Saw - for cutting aluminum extrusion
2. Drill
3. Impact Drill
4. Hammer Drill (with bit for anchoring brackets into deck)
5. Square
6. Tape Measure
7. 5/16" Hex Drill Driver
8. #2 Phillips Drill Bit
9. 7/8" Drill Bit - for drilling out hole for lid lock
10. 1/8" Drill Bit
11. 9/16" Wrench
12. 9/16" Socket
13. Pencil or Marker
14. 3/8" Concrete Anchor Bolts



PARTS LIST

X0857
QTY: 2

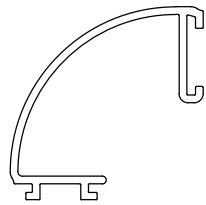

56022
QTY: 4

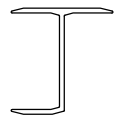

X0009
QTY: 3

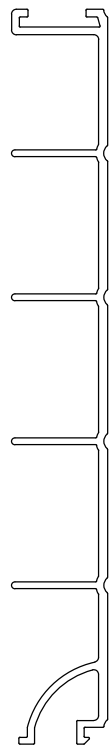

X0008
QTY: 3

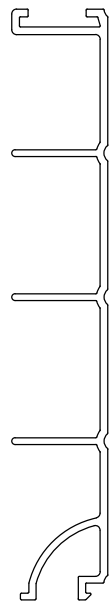

M1050
QTY: 2

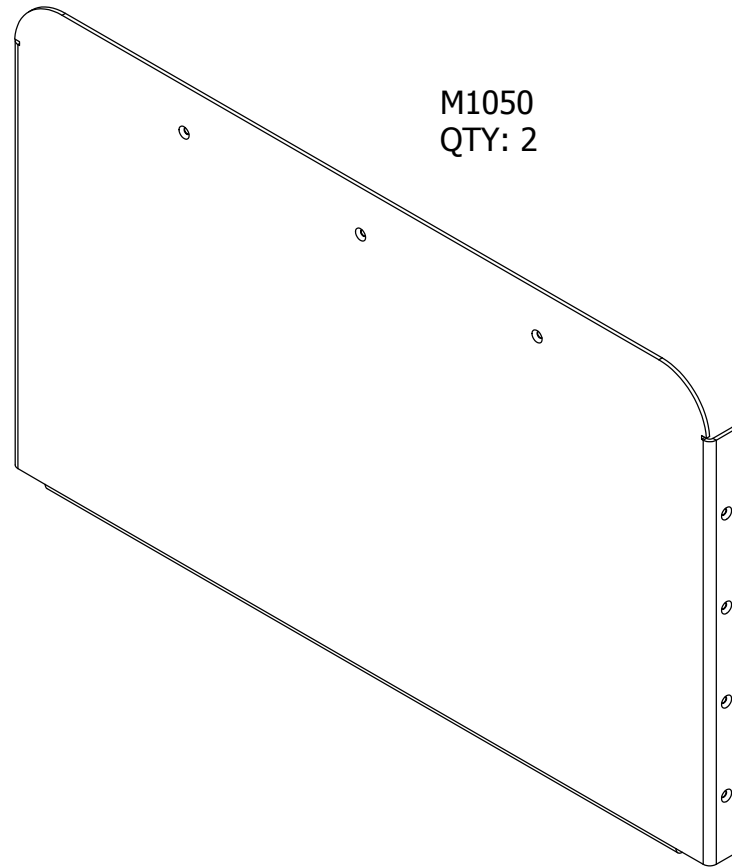

M9091
QTY: 1

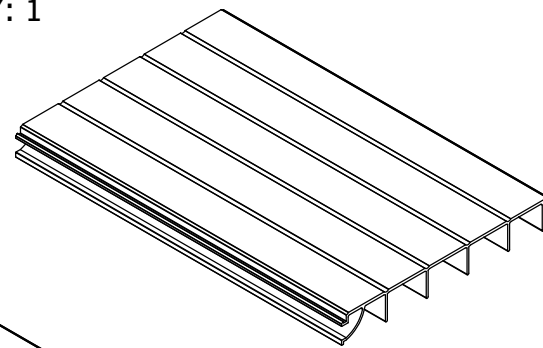

M9090
QTY: 1

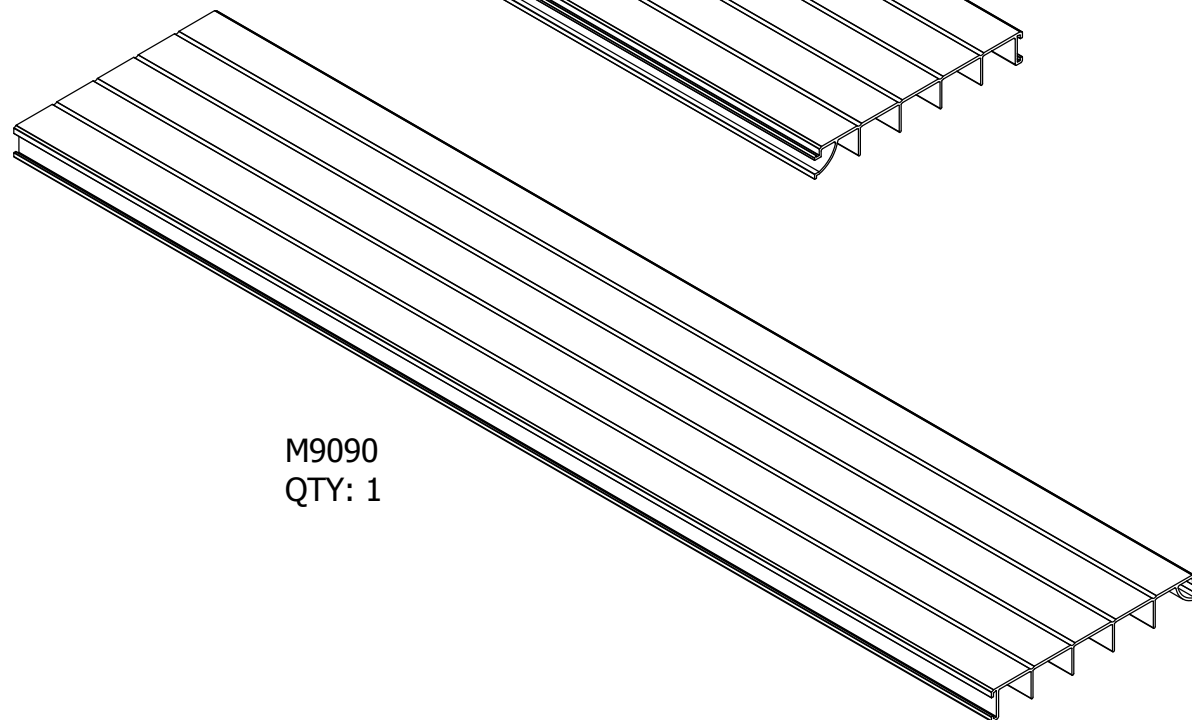

A3380 ALUMINUM BENCH HARDWARE INSTALL KIT

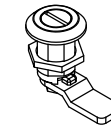

H1122
QTY: 2



33237
QTY: 8



H0700
QTY: 26



33278
QTY: 6

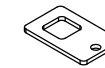

M1033
QTY: 2

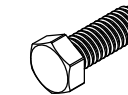

H0203
QTY: 8

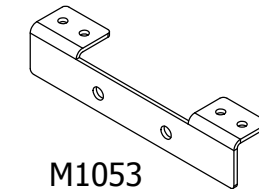

M1053
QTY: 8

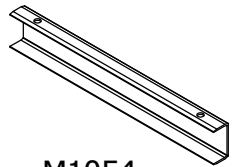

M1054
QTY: 2



H0313
QTY: 35

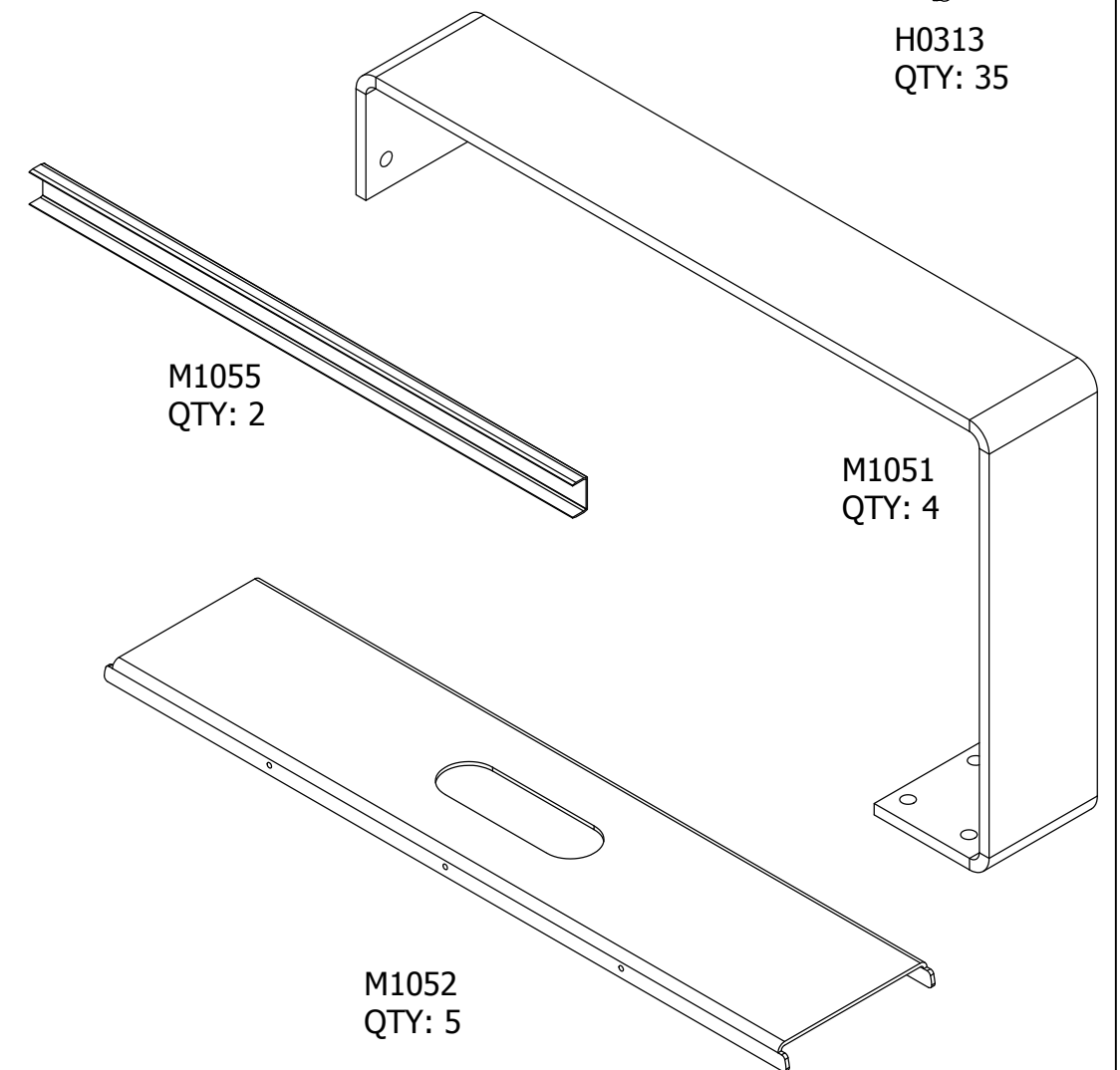

M1055
QTY: 2

M1051
QTY: 4

M1052
QTY: 5



1
MEASURE

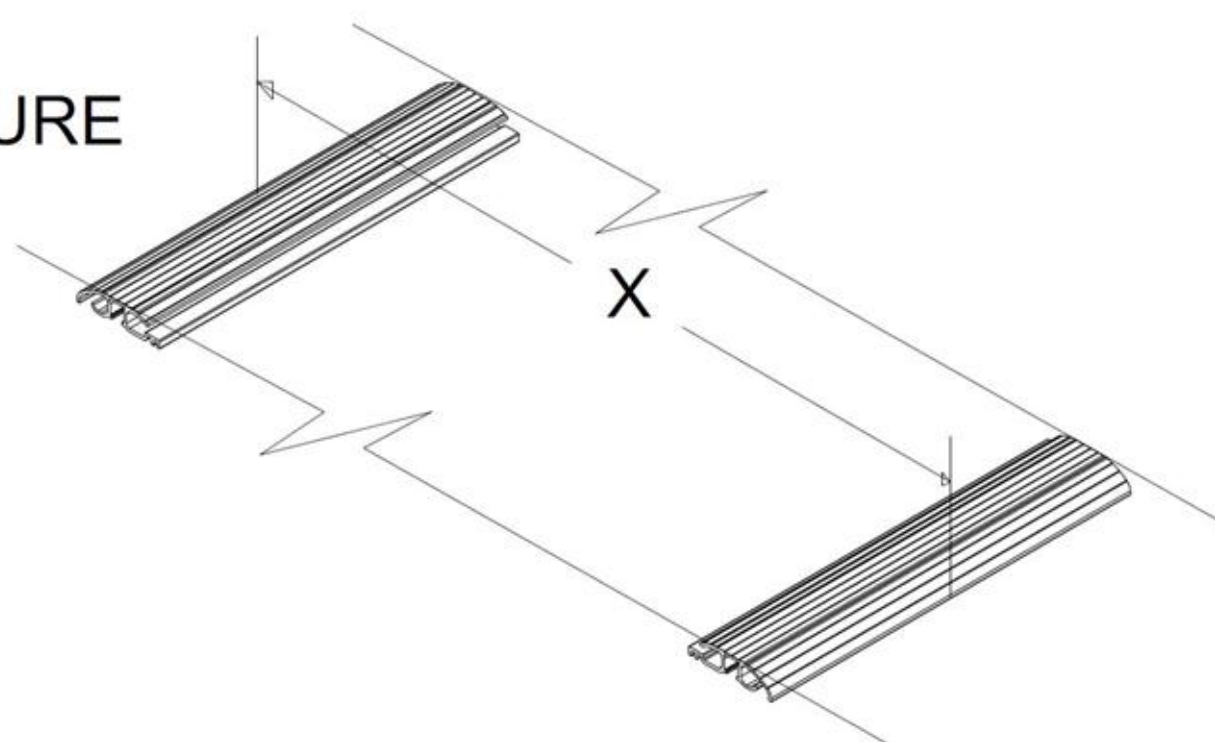

2
CUT

X0008 - 6" LID
2 @ (X + 48.25") - RISER
1 @ (X + 48") - LID

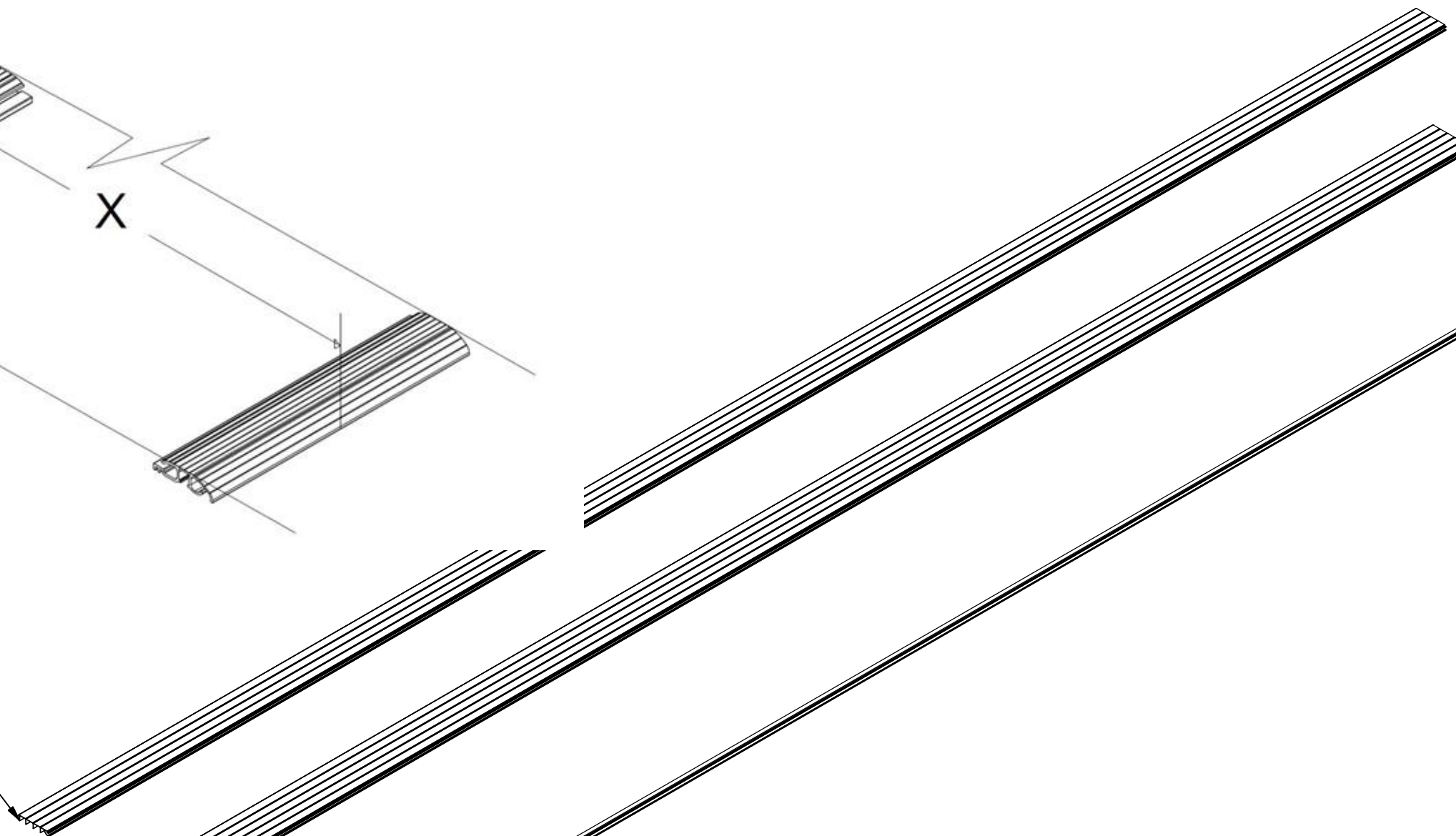

X0009 - 7.5" LID
1 @ (X + 48.25) RISER
2 @ (X + 48) LID

**X0857 - ROUNDED
CORNER EXTRUSION**
2 @ (X + 48.25)

3 - LID ASSEMBLY

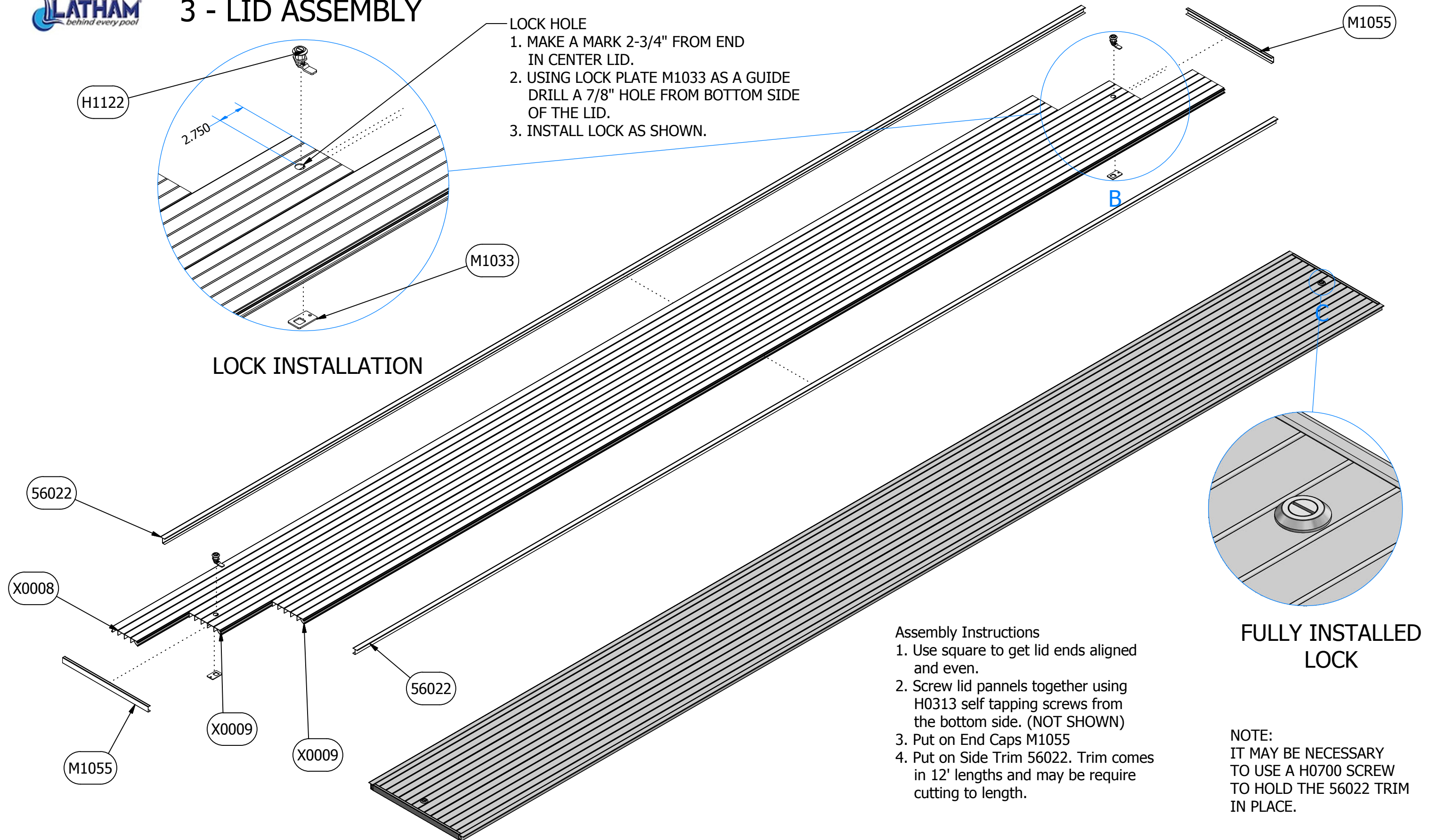



4 - FRONT AND BACK RISER ASSEMBLY

SHOWING BUILT AS A MOTOR SIDE RIGHT BENCH.
TO MAKE IT A MOTOR SIDE LEFT BENCH
SWAP **M9090** AND **M9091** SIDES.

- Assembly Instructions
1. Use square to get lid ends aligned and even.
 2. Screw lid pannels together using H0313 self tapping screws from the back side. (NOT SHOWN)

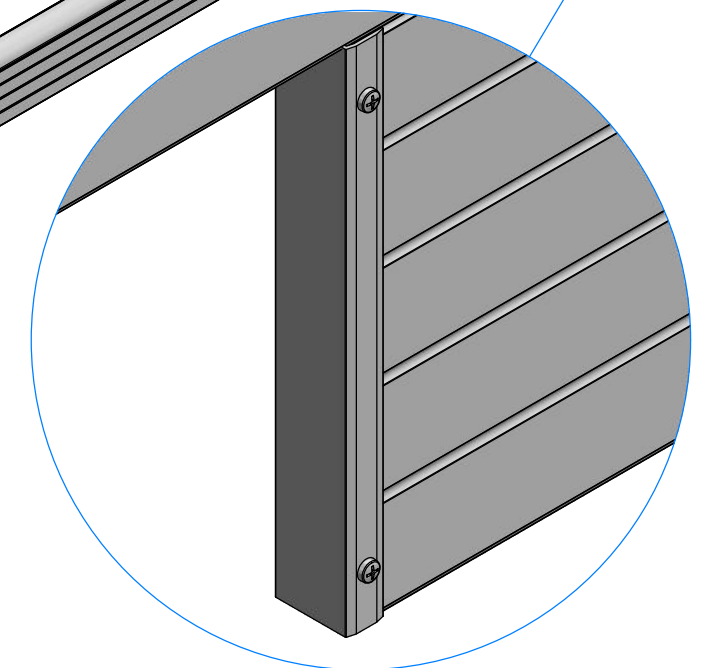
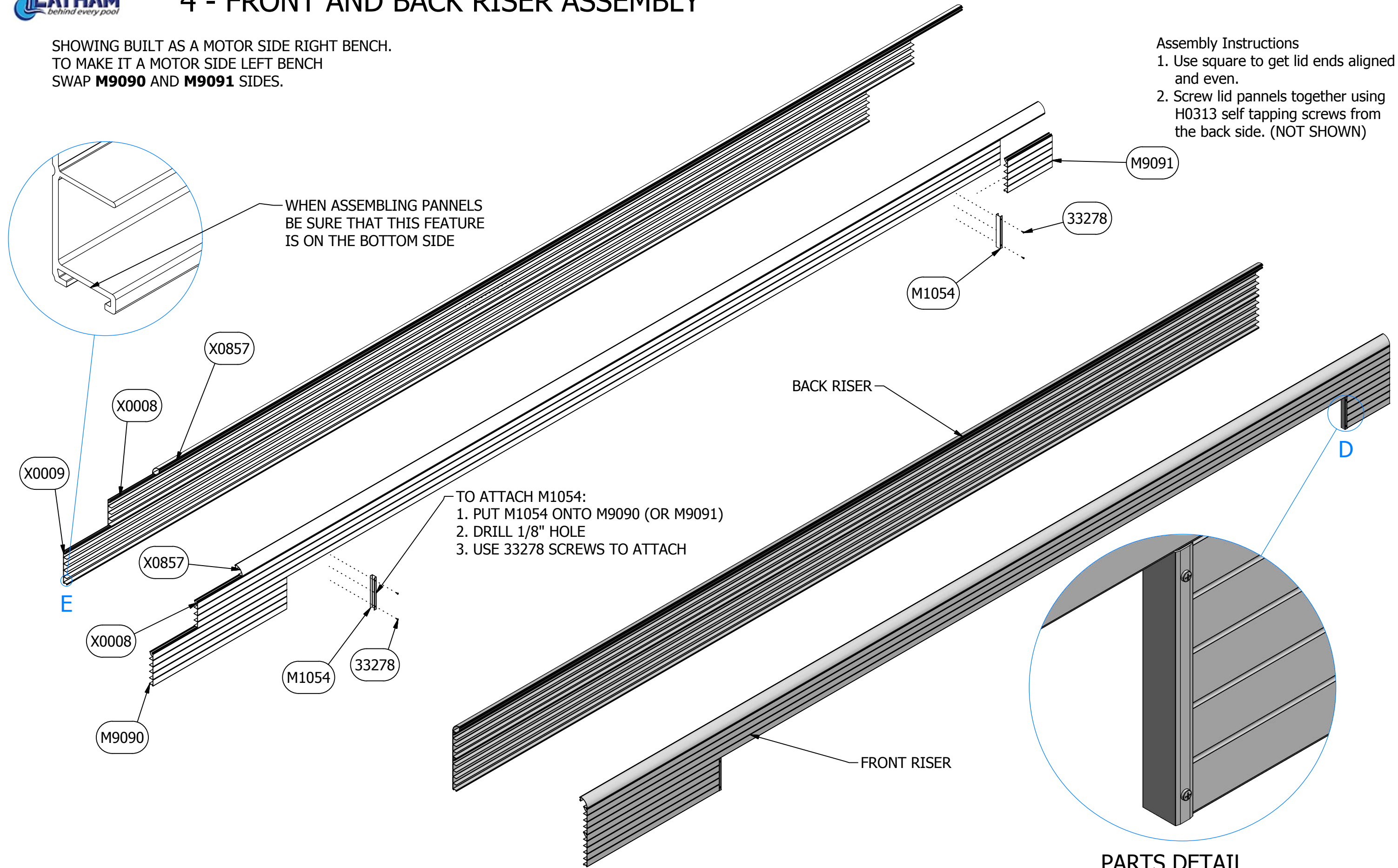

PARTS DETAIL

5- SUPPORT BRACKET

M1051 BENCH BRACKET DECK ATTACHMENT:

1. FLIP A CHALK LINE WHERE THE BACK OF THE BENCH BRACKETS WILL GO.
2. BRING IN BRACKETS 36" FROM EACH END.
3. SPACE MIDDLE 2 BRACKETS EVENLY
4. PUT THE BACK OF BRACKET ON THE CHALK LINE.
5. DRILL AND ANCHOR BRACKETS USING 3/8" ANCHOR BOLTS. (NOT SHOWN)
6. ATTACH M1053 BRACKETS TO M1051 USING H0203 AND 33237 FASTENERS

*MAY REQUIRE SHIMING TO KEEP BRACKETS AT CORRECT ELEVATION IF DECK IS UNEVEN.

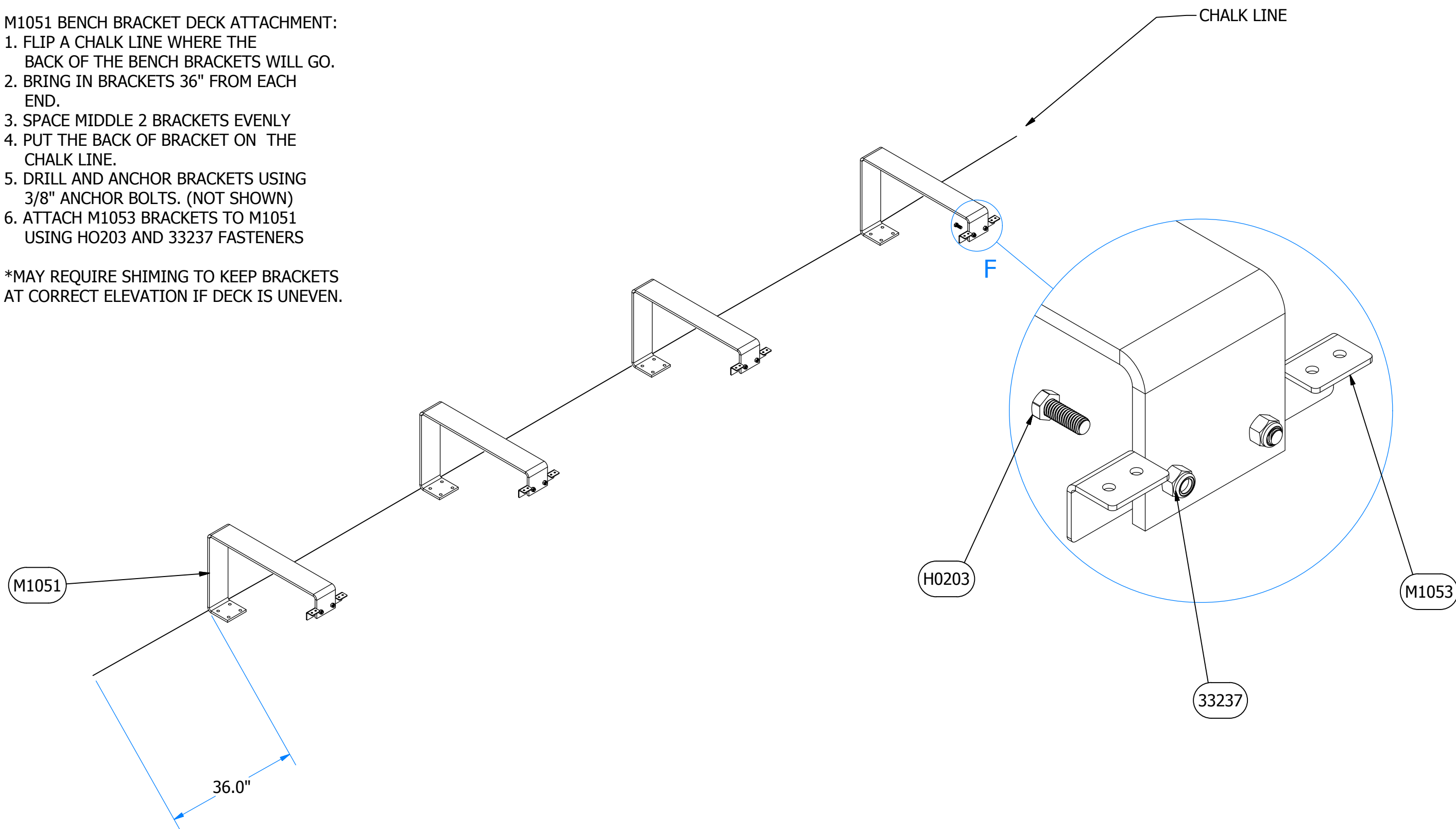

6 - END PLATE & LID PLATE

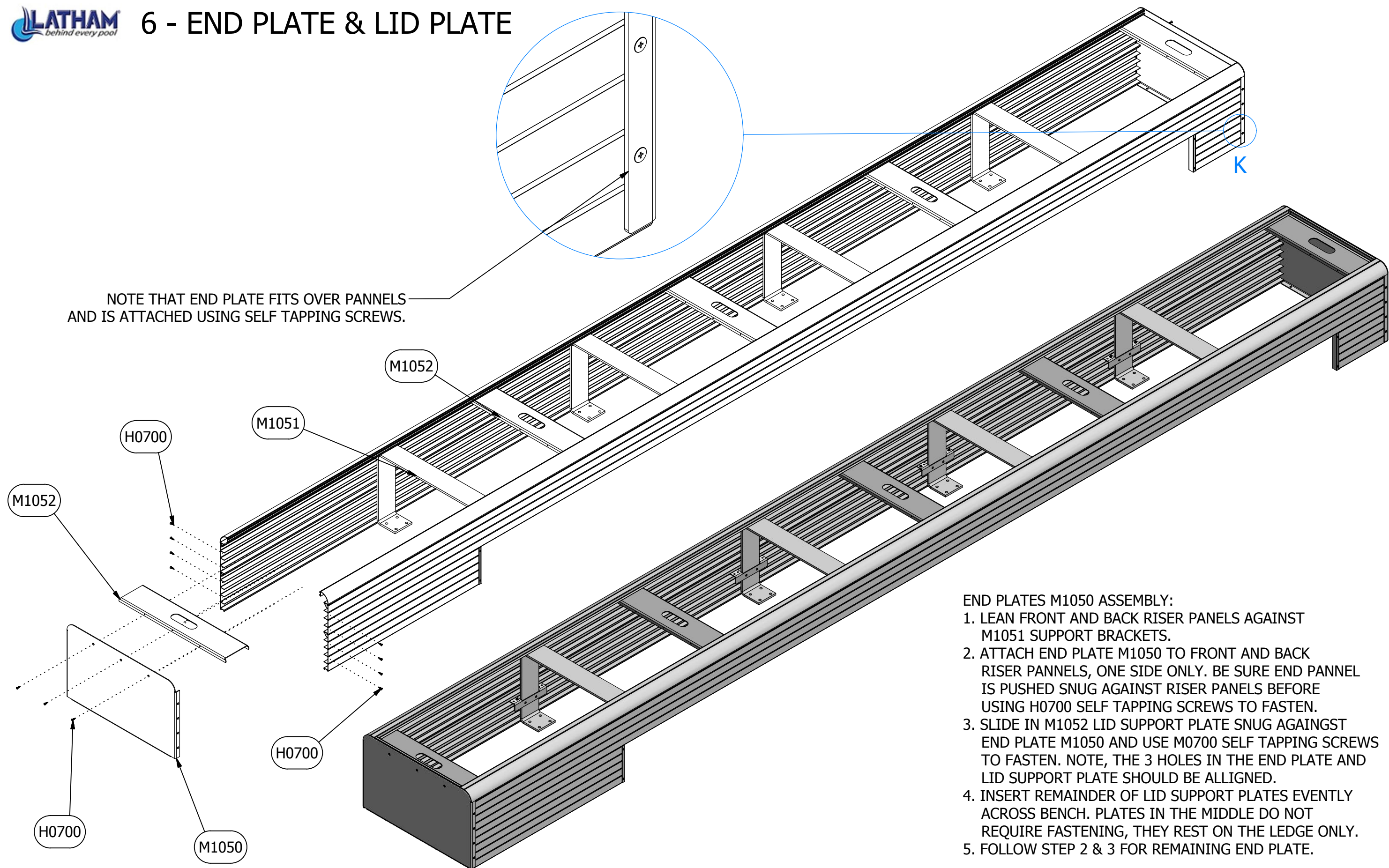

END PLATES M1050 ASSEMBLY:

1. LEAN FRONT AND BACK RISER PANELS AGAINST M1051 SUPPORT BRACKETS.
2. ATTACH END PLATE M1050 TO FRONT AND BACK RISER PANNELS, ONE SIDE ONLY. BE SURE END PANNEL IS PUSHED SNUG AGAINST RISER PANELS BEFORE USING H0700 SELF TAPPING SCREWS TO FASTEN.
3. SLIDE IN M1052 LID SUPPORT PLATE SNUG AGAINST END PLATE M1050 AND USE M0700 SELF TAPPING SCREWS TO FASTEN. NOTE, THE 3 HOLES IN THE END PLATE AND LID SUPPORT PLATE SHOULD BE ALLIGNED.
4. INSERT REMAINDER OF LID SUPPORT PLATES EVENTLY ACROSS BENCH. PLATES IN THE MIDDLE DO NOT REQUIRE FASTENING, THEY REST ON THE LEDGE ONLY.
5. FOLLOW STEP 2 & 3 FOR REMAINING END PLATE.

7. M1053 ATTACHMENT BRACKET

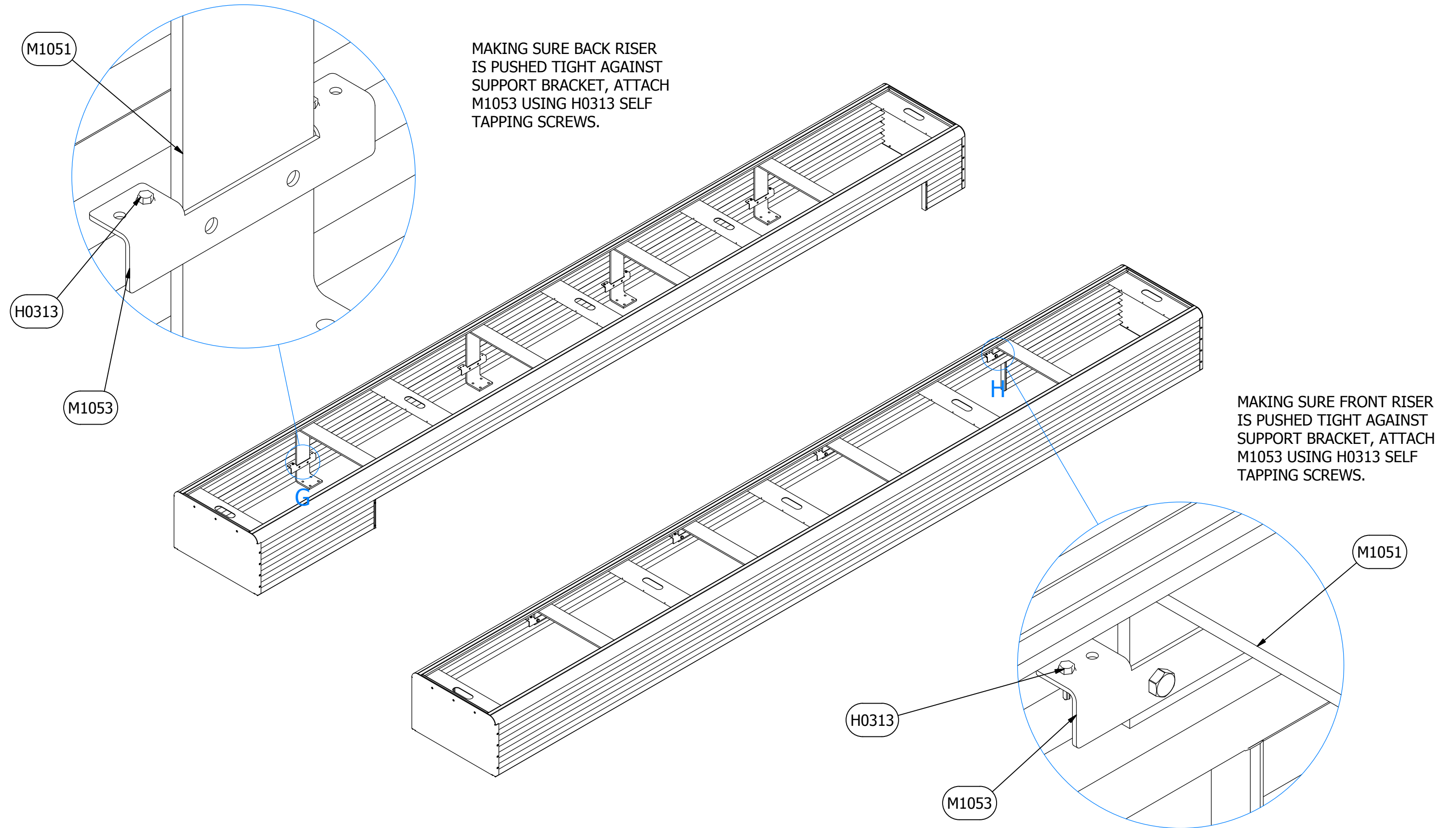



8. LID ATTACHMENT

LID ASSEMBLY

1. DROP LID INTO PLACE
2. TURN LOCKS TO
LOCK LID INTO PLACE
3. CHECK PLASTIC LID TRIM
TO MAKE SURE IT IS SEATED
PROPERLY. ROUND OFF
ANY SHARP CORNERS.

* IT MAY BE NECESSARY TO
USE A SELF TAPPING SCREW
H0700 TO HOLD THE 56022
LID TRIM IN PLACE.

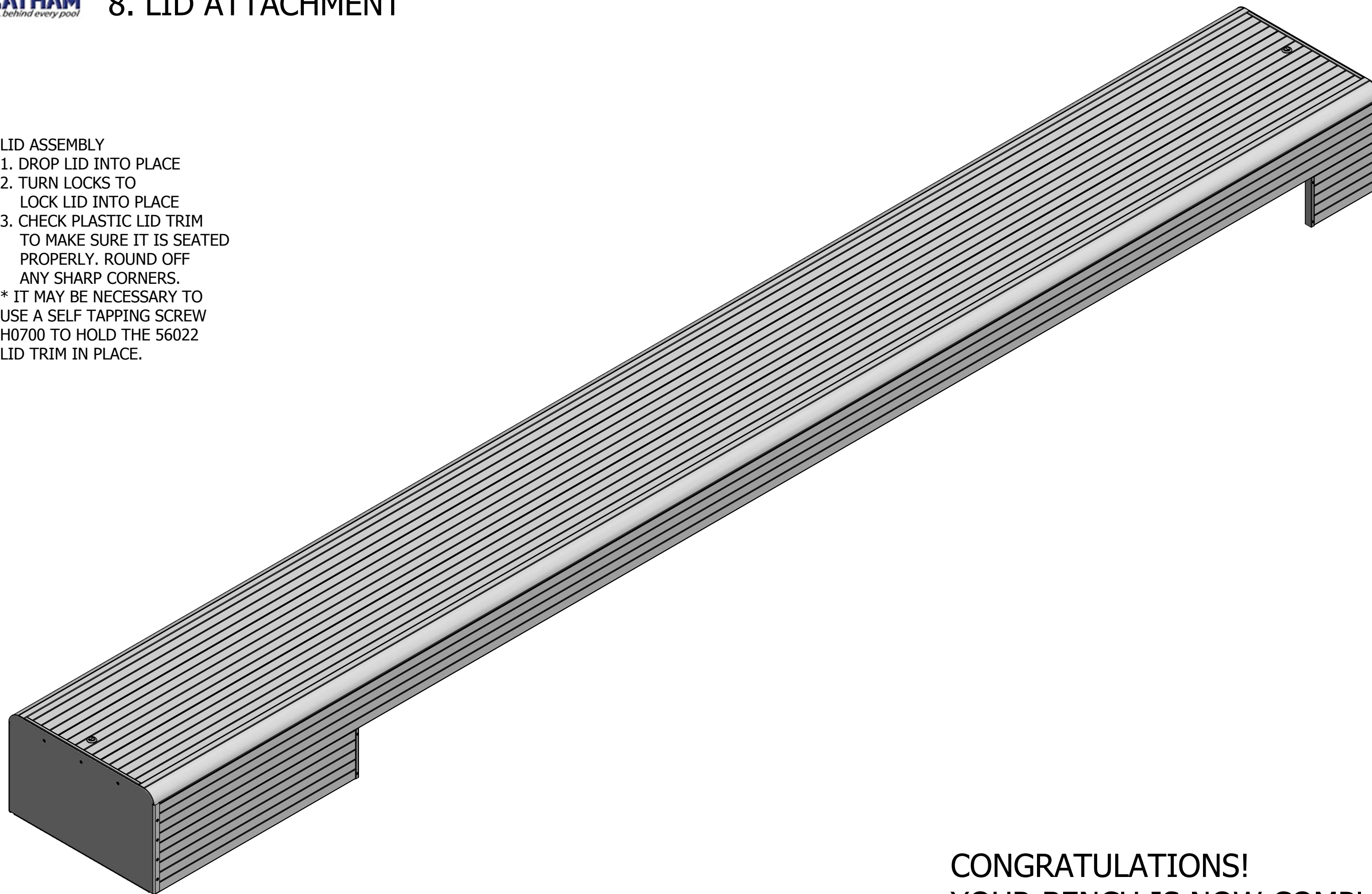

CONGRATULATIONS!
YOUR BENCH IS NOW COMPLETE.